

SCALE IN FEET

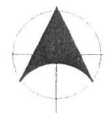

NORTH

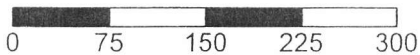
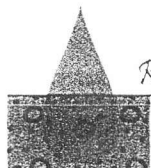

RJN Environmental Services, LLC

Surface Water Studies
Groundwater Studies
Site Investigations



4631 COUNTY ROAD A OREGON, WISCONSIN 53575 (608) 576-3001

MADISON-KIPP CORPORATION
MADISON, WISCONSIN
GROUNDWATER MONITOR WELL LOCATIONS

FIGURE
1

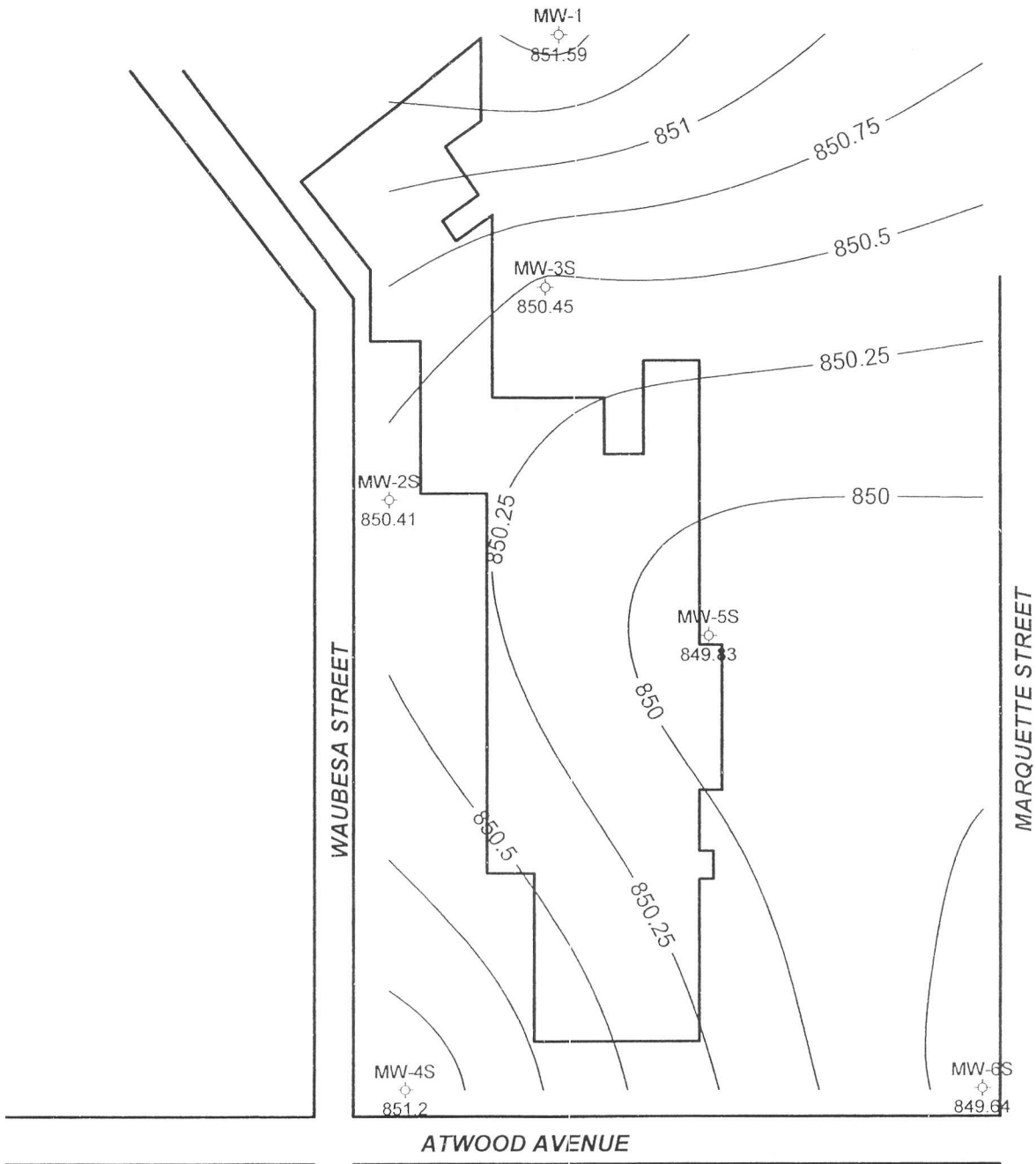
DRAWN BY	PROJ. No.	DATE	FILE NAME
RN	09-101	22 JAN 10	WELL LOC

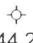

 MONITOR WELL WITH GROUNDWATER ELEVATION (FT, MSL)
 845 GROUNDWATER ELEVATION (FEET, MSL)

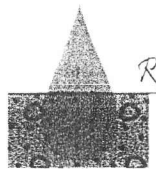
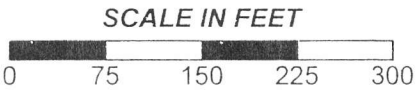

RJN Environmental Services, LLC

Surface Water Studies
Groundwater Studies
Site Investigations

4631 COUNTY ROAD A OREGON, WISCONSIN 53575 (608) 576-3001

MADISON-KIPP CORP. MADISON, WISCONSIN WATER TABLE JULY 1, 2010			FIGURE 2
DRAWN BY	PROJ. No.	DATE	FILE NAME
RN	09-101	07 JAN 11	WT 070110

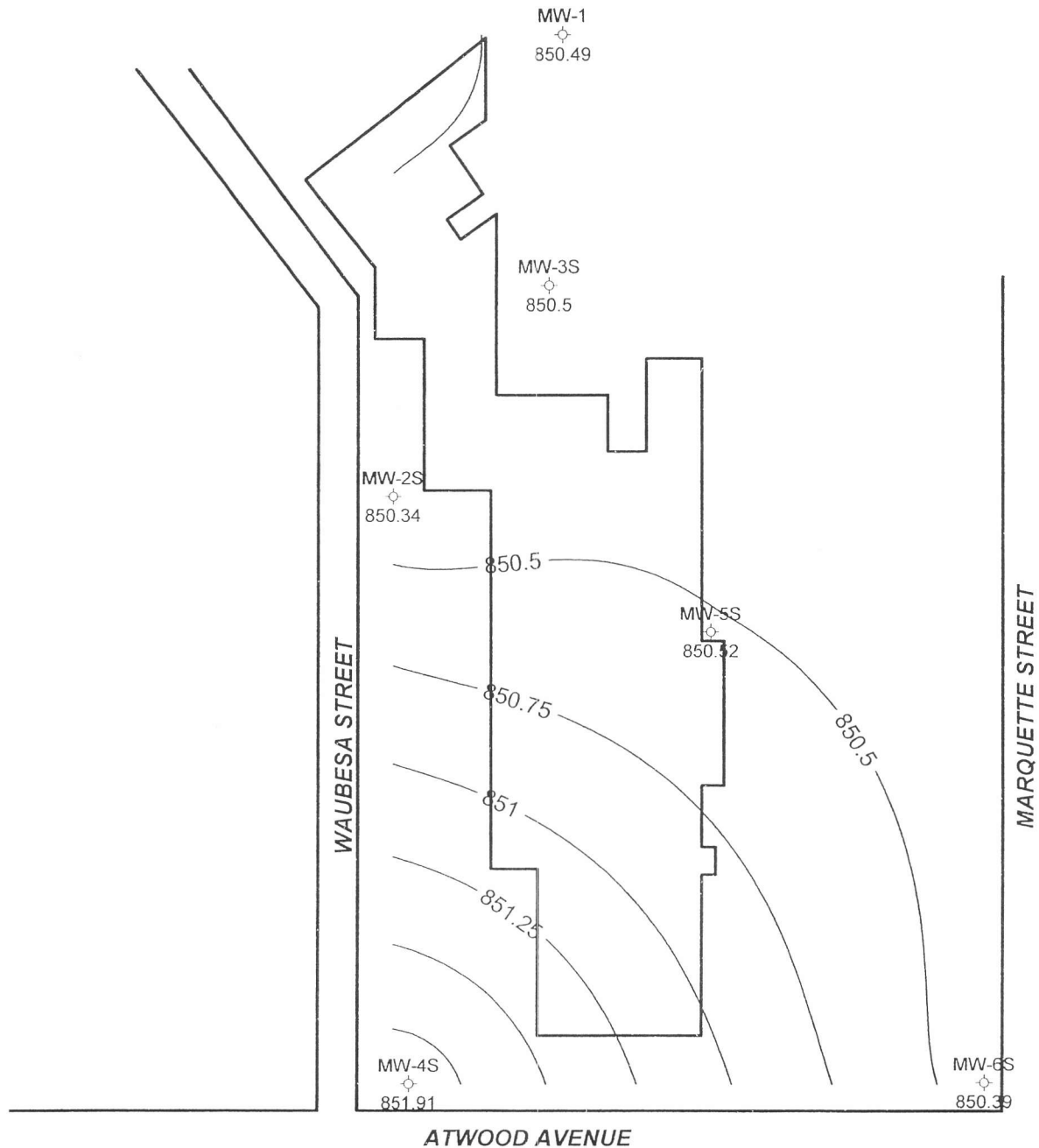

ATWOOD AVENUE

844.21 MONITOR WELL WITH
GROUNDWATER ELEVATION (FT, MSL)
 845 GROUNDWATER ELEVATION
(FEET, MSL)



NORTH

SCALE IN FEET

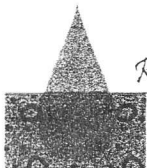
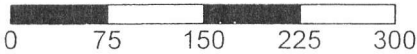

RIN Environmental Services, LLC

Surface Water Studies
Groundwater Studies
Site Investigations

4631 COUNTY ROAD A OREGON, WISCONSIN 53575 (608) 576-3001

MADISON-KIPP CORP.
MADISON, WISCONSIN
WATER TABLE
OCTOBER 1, 2010

FIGURE
3

DRAWN BY	PROJ. No.	DATE	FILE NAME
RN	09-101	06 JAN 11	WT 100110

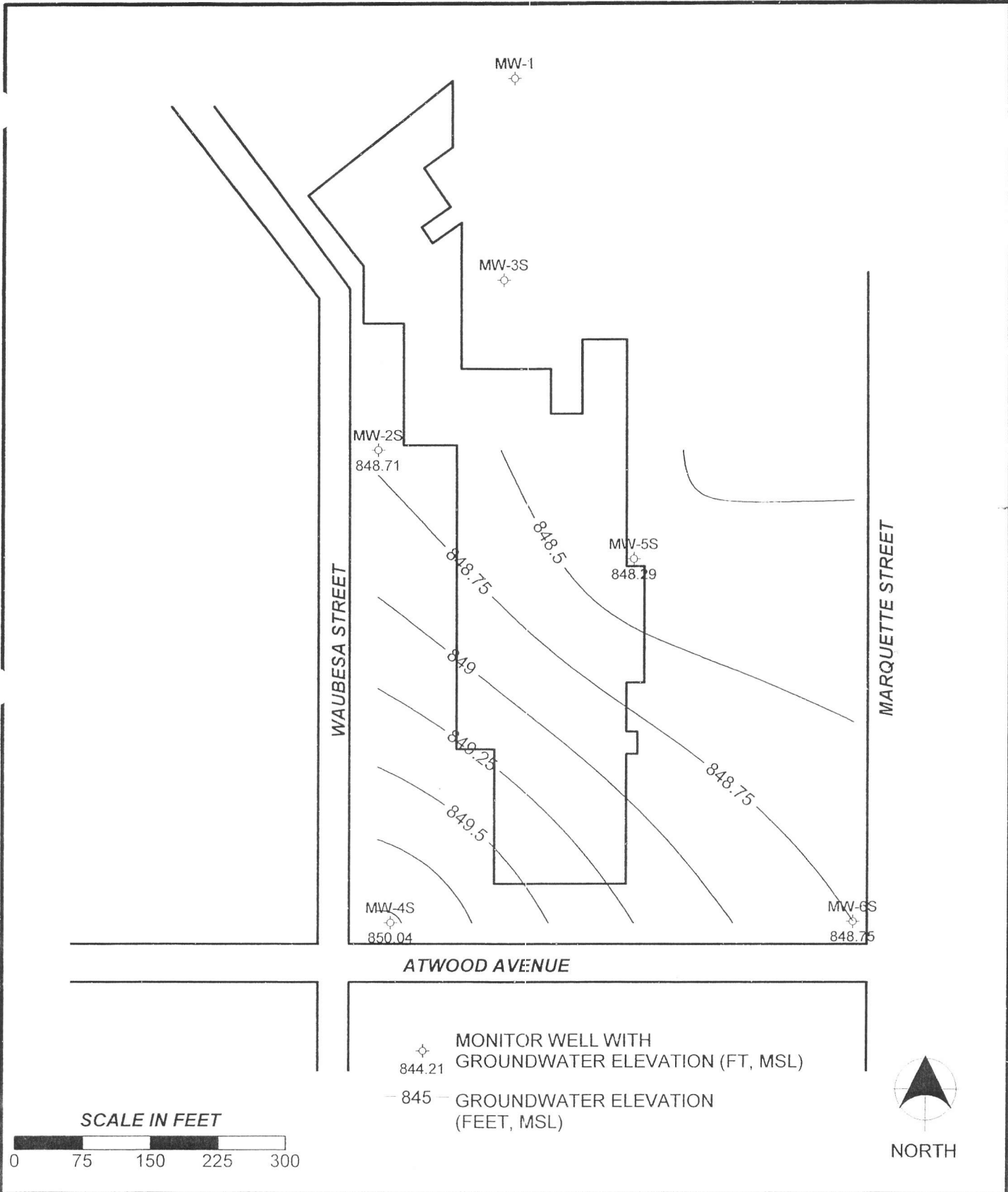

RIN Environmental Services, LLC
 Surface Water Studies
 Groundwater Studies
 Site Investigations

4631 COUNTY ROAD A OREGON, WISCONSIN 53575 (608) 576-3001

MADISON-KIPP CORP. MADISON, WISCONSIN WATER TABLE DECEMBER 28, 2010			
DRAWN BY	PROJ. No.	DATE	FILE NAME
RN	09-101	07 JAN 11	WT 122810

FIGURE
4

 MONITOR WELL WITH
 GROUNDWATER ELEVATION (FT, MSL)
 — 845 — GROUNDWATER ELEVATION
 (FEET, MSL)

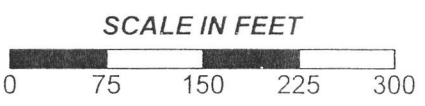
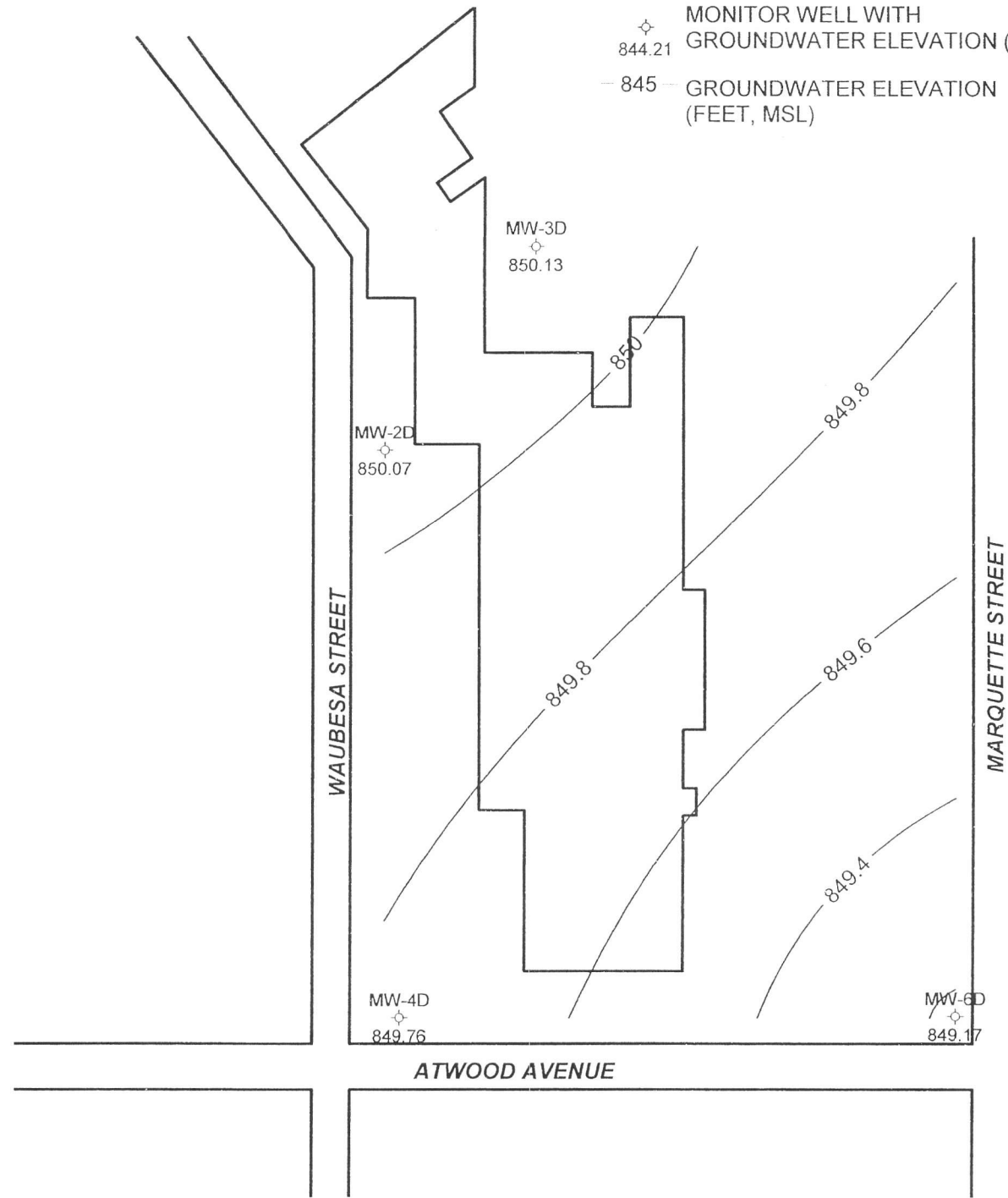

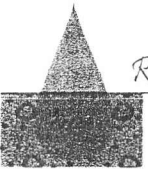
 <p> RIN Environmental Services, LLC Surface Water Studies Groundwater Studies Site Investigations 4631 COUNTY ROAD A OREGON, WISCONSIN 53575 (608) 676-3001 </p>	MADISON-KIPP CORPORATION MADISON, WISCONSIN INTERMEDIATE WATER LEVELS JULY 1, 2010			FIGURE 5
	DRAWN BY	PROJ. No.	DATE	FILE NAME
	RN	09-101	07 JAN 11	INT 070110

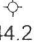
 MONITOR WELL WITH
 844.21 GROUNDWATER ELEVATION (FT, MSL)
 — 845 — GROUNDWATER ELEVATION
 (FEET, MSL)

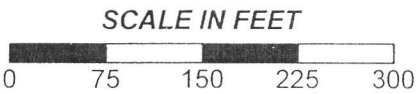
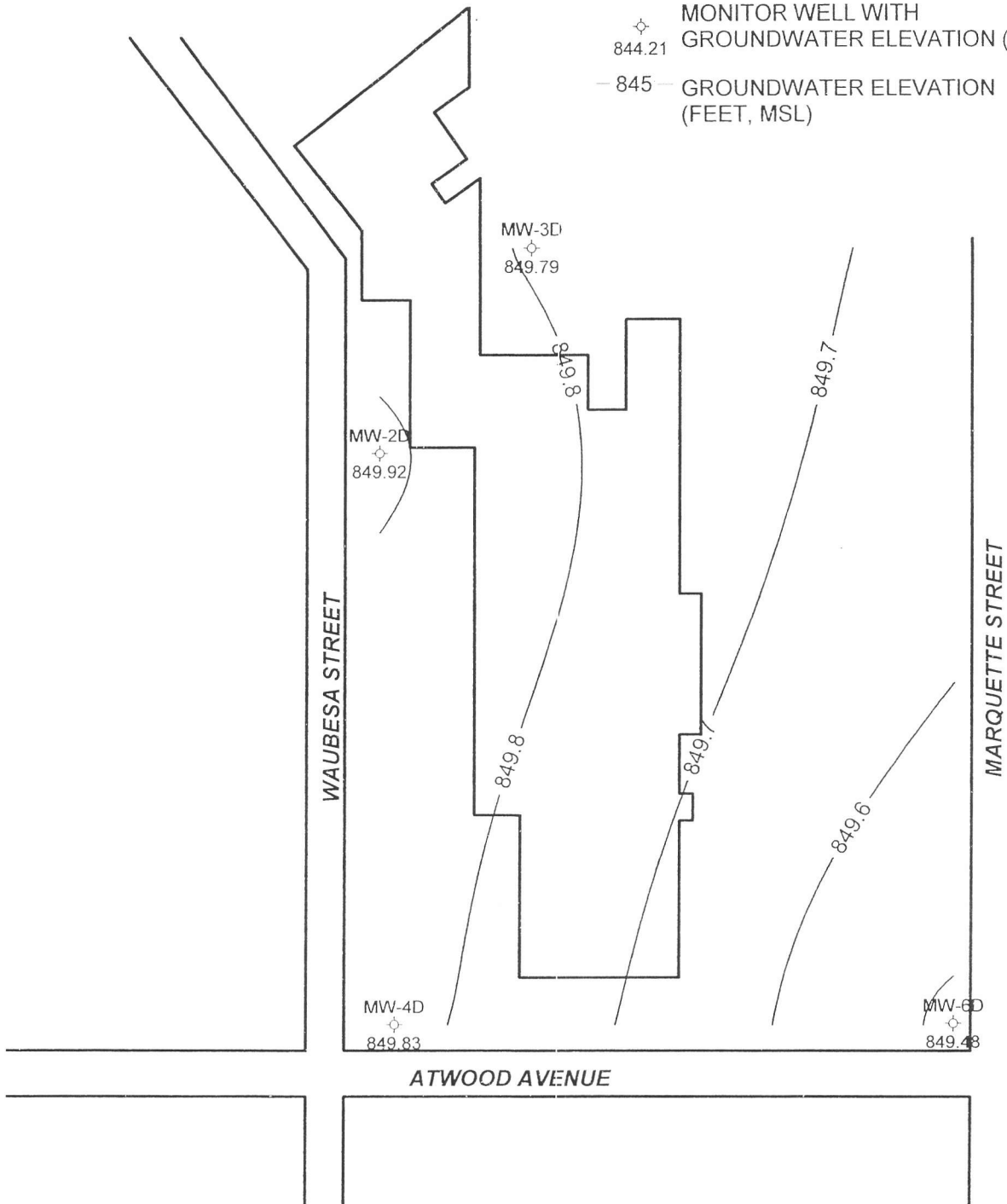

NORTH

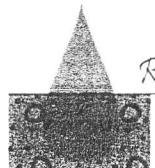

RIN Environmental Services, LLC

Surface Water Studies
 Groundwater Studies
 Site Investigations

4631 COUNTY ROAD A OREGON, WISCONSIN 53575 (608) 576-3001

MADISON-KIPP CORPORATION
 MADISON, WISCONSIN
 INTERMEDIATE WATER LEVELS
 OCTOBER 1, 2010

FIGURE
6

DRAWN BY

PROJ. No.

DATE

FILE NAME

RN

09-101

07 JAN 11

INT 100110

 MONITOR WELL WITH
 844.21 GROUNDWATER ELEVATION (FT, MSL)
 — 845 — GROUNDWATER ELEVATION
 (FEET, MSL)

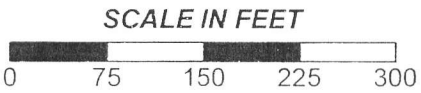
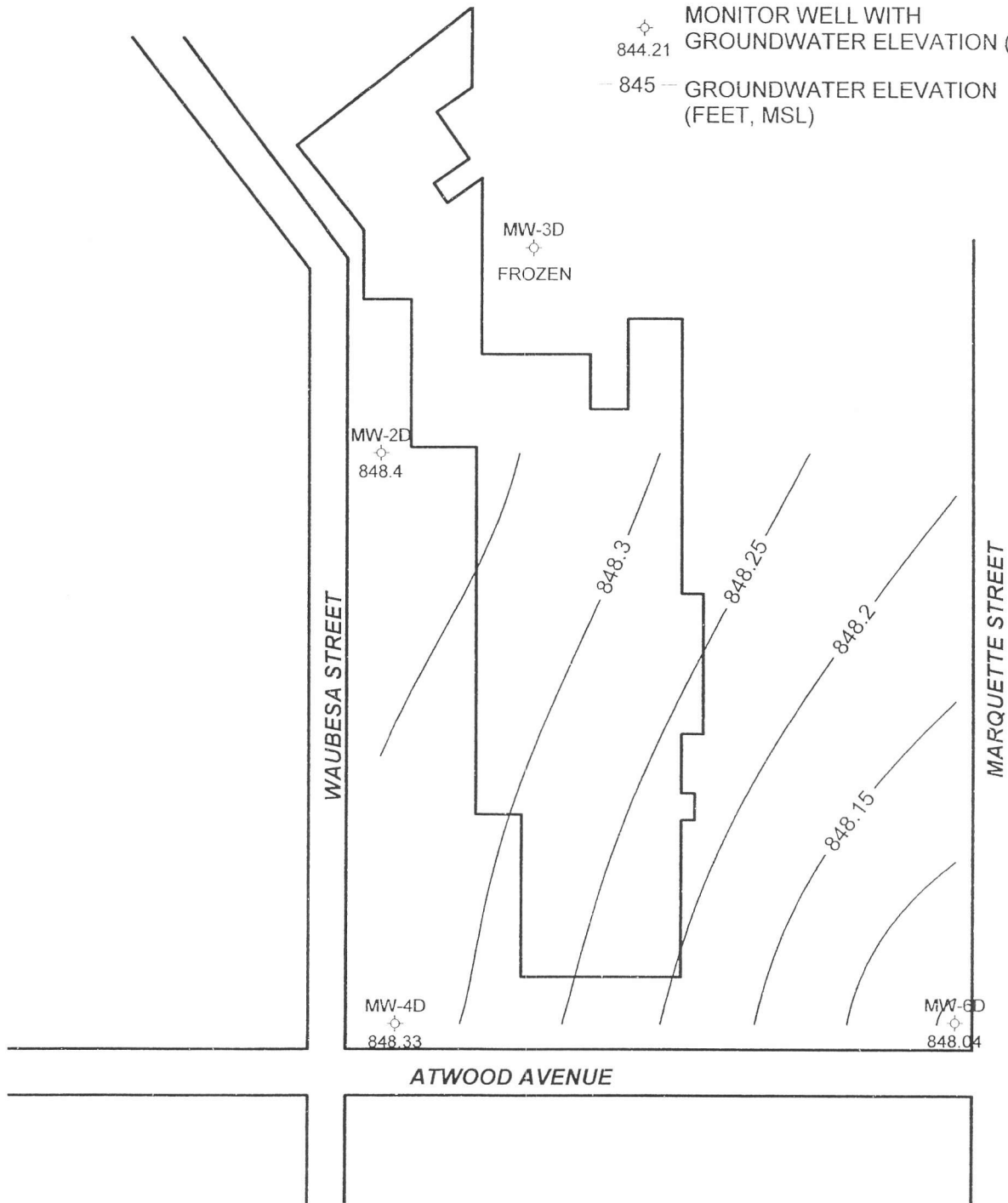

NORTH

MADISON-KIPP CORPORATION
 MADISON, WISCONSIN
 INTERMEDIATE WATER LEVELS
 DECEMBER 28, 2010

FIGURE
7

DRAWN BY	PROJ. No.	DATE	FILE NAME
RN	09-101	07 JAN 11	INT 122810

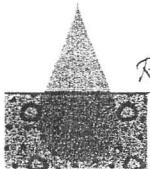

RJN Environmental Services, LLC

Surface Water Studies
 Groundwater Studies
 Site Investigations

4631 COUNTY ROAD A OREGON, WISCONSIN 53575 (608) 576-3001

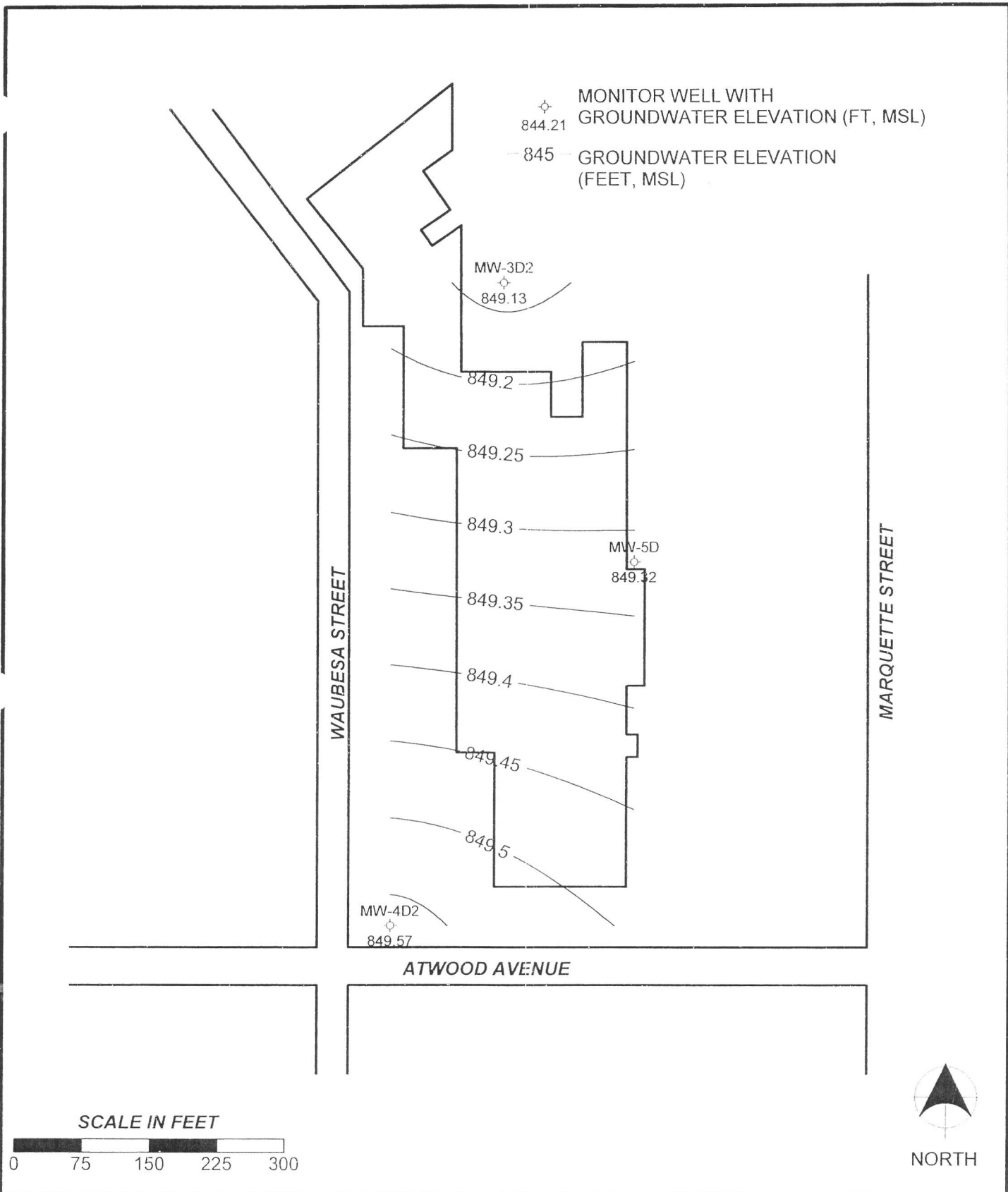

RIN Environmental Services, LLC

Surface Water Studies
Groundwater Studies
Site Investigations

4531 COUNTY ROAD A OREGON, WISCONSIN 53575 (608) 576-3001

MADISON-KIPP CORPORATION MADISON, WISCONSIN DEEP WATER LEVELS JULY 1, 2010		
DRAWN BY	PROJ. No.	DATE
RN	09-101	07 JAN 11

FIGURE
8

FILE NAME
DEEP 070110

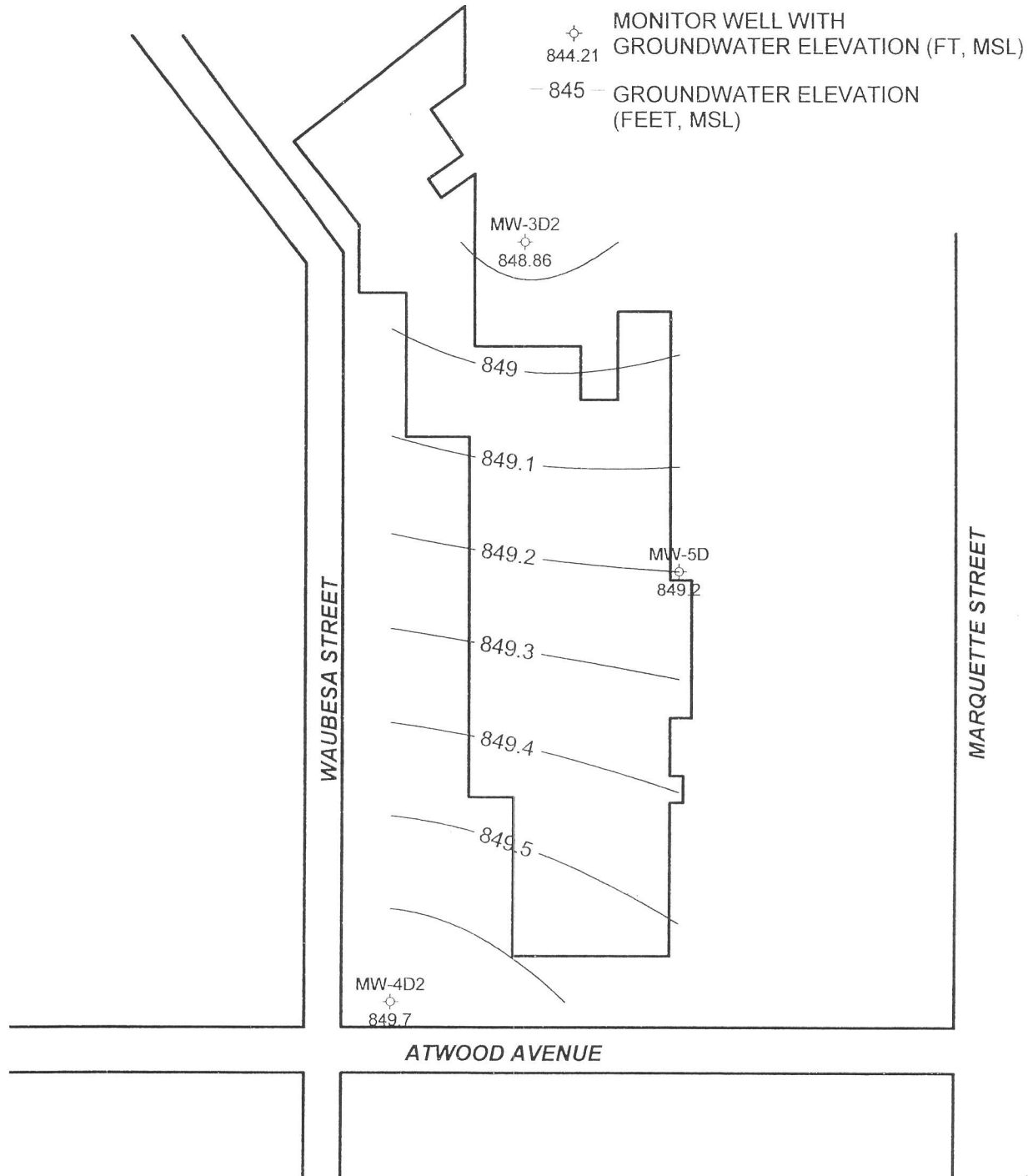

SCALE IN FEET

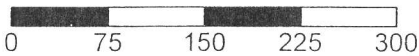

NORTH

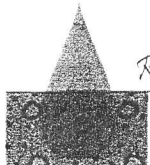

RJN Environmental Services, LLC

Surface Water Studies
 Groundwater Studies
 Site Investigations

4631 COUNTY ROAD A OREGON, WISCONSIN 53575 (608) 576-3001

MADISON-KIPP CORPORATION
 MADISON, WISCONSIN
 DEEP WATER LEVELS
 OCTOBER 1, 2010

FIGURE
 9

DRAWN BY	PROJ. No.	DATE	FILE NAME
RN	09-101	07 JAN 11	DEEP 100110

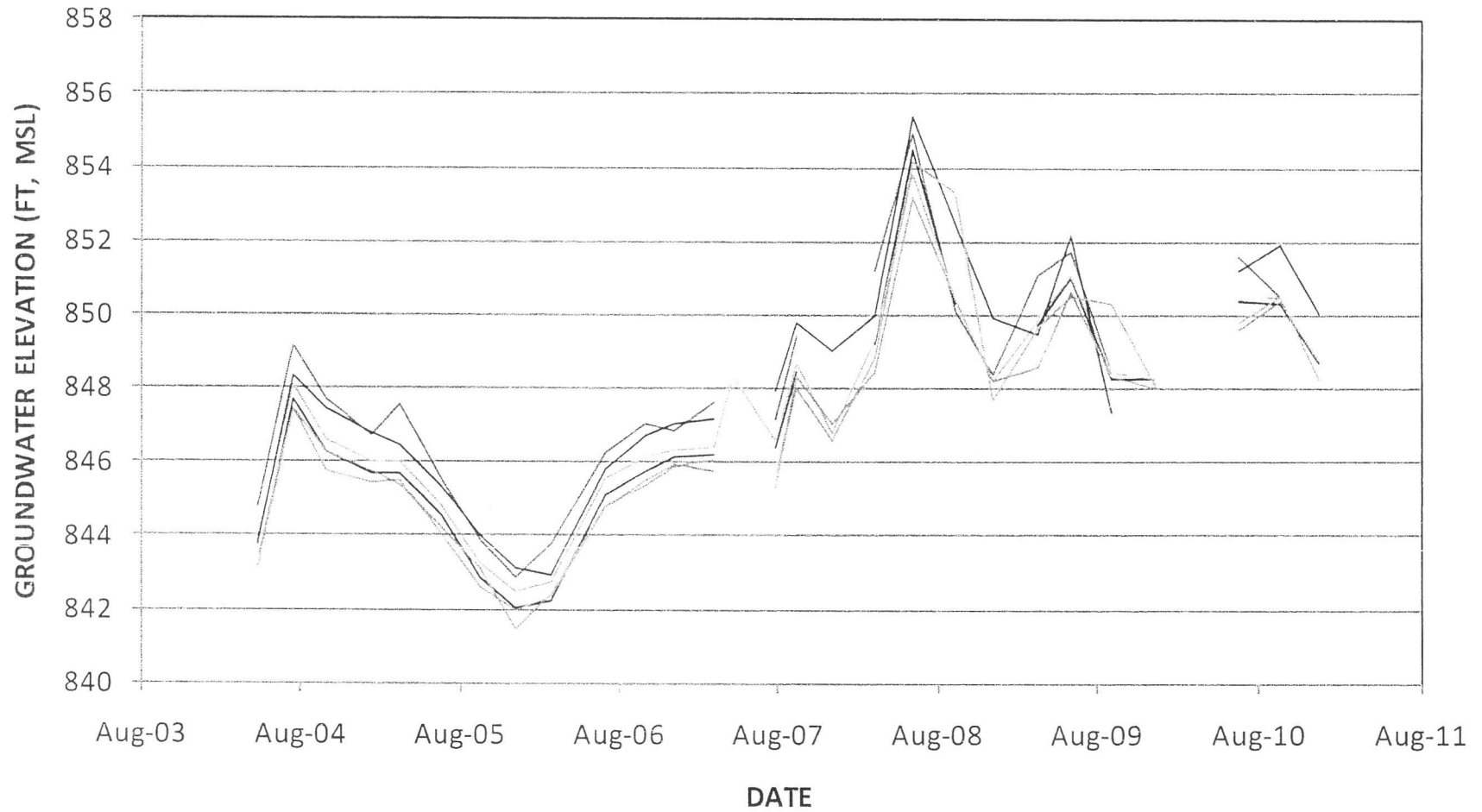

— MW-1 — MW-2S — MW-3S — MW-4S — MW-5S — MW-6S

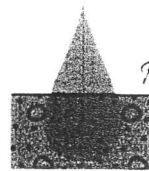

RJN Environmental Services, LLC

Surface Water Studies
Groundwater Studies
Site Investigations

4631 COUNTY ROAD A OREGON, WISCONSIN 53575 (608) 576-3001

MADISON-KIPP CORPORATION
MADISON, WISCONSIN
SHALLOW WELL HYDROGRAPHS

FIGURE
10

DRAWN BY

PROJ. No.

DATE

FILE

RN

09-101

13 JAN 11

WT HYDRO

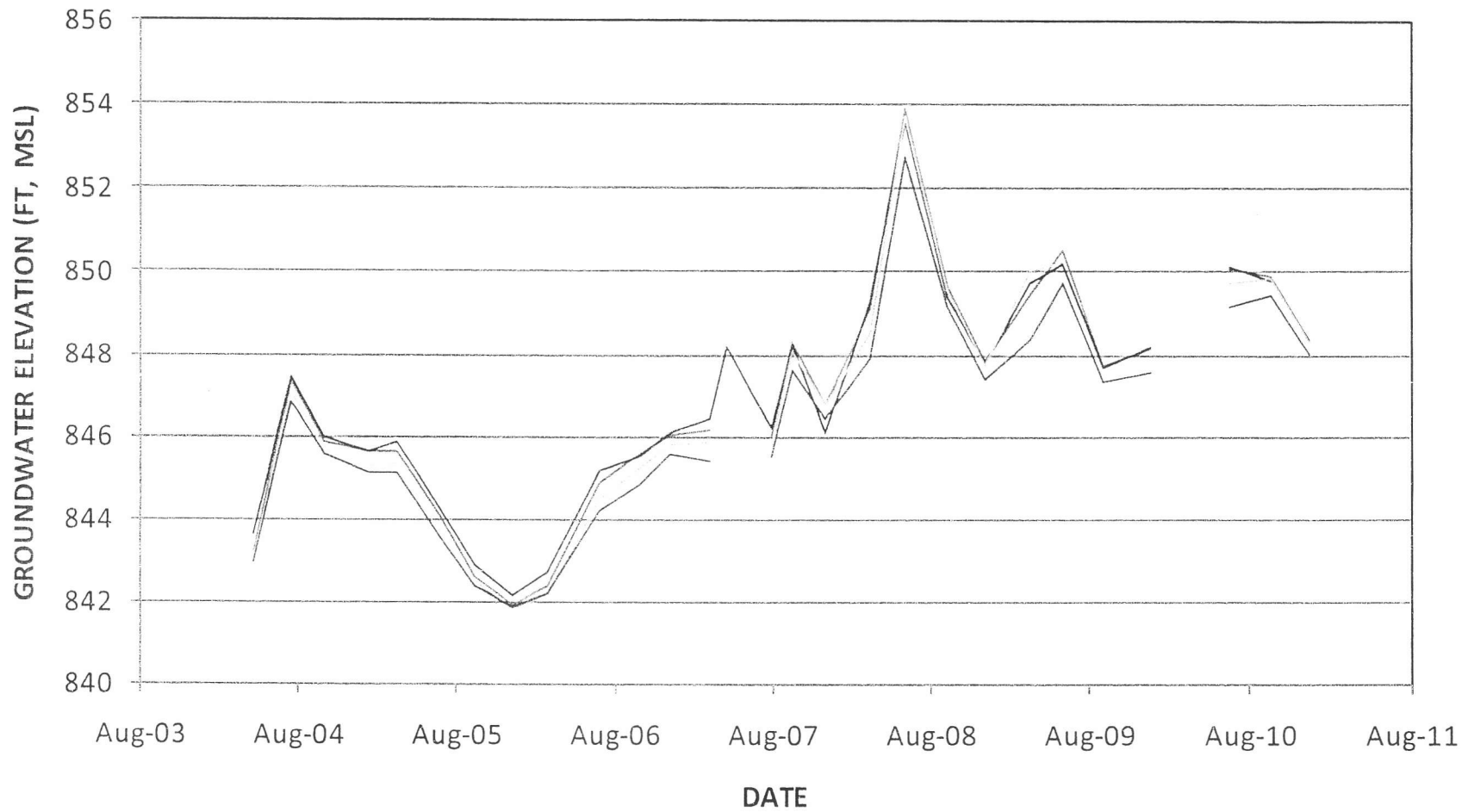

— MW-2D — MW-3D — MW-4D — MW-6D

R/N Environmental Services, LLC
 Surface Water Studies
 Groundwater Studies
 Site Investigations

4631 COUNTY ROAD A OREGON, WISCONSIN 53575 (608) 576-3001

MADISON-KIPP CORPORATION
 MADISON, WISCONSIN
 INTERMEDIATE WELL HYDROGRAPHS

FIGURE
11

DRAWN BY	PROJ. No.	DATE
RN	09-101	13 JAN 11

FILE
 INT HYDRO

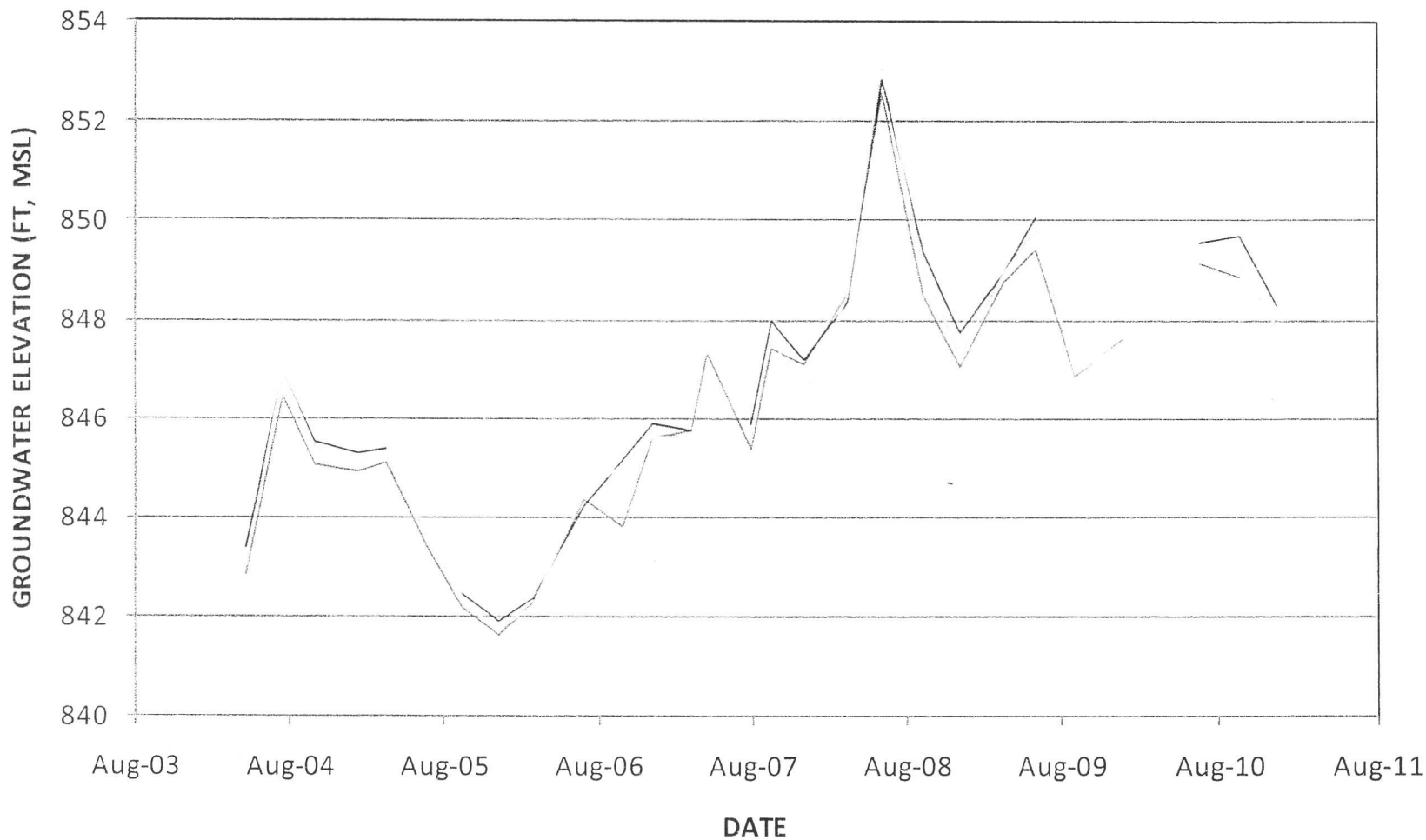

— MW-3D2 — MW-4D2 — MW-5D

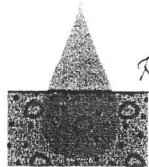

RJN Environmental Services, LLC

Surface Water Studies
Groundwater Studies
Site Investigations

4631 COUNTY ROAD A OREGON, WISCONSIN 53575 (608) 576-3001

MADISON-KIPP CORPORATION
MADISON, WISCONSIN
DEEP WELL HYDROGRAPHS

FIGURE
12

DRAWN BY	PROJ. No.	DATE	FILE
RN	09-101	13 JAN 11	DEEP HYDRO

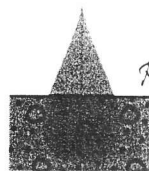
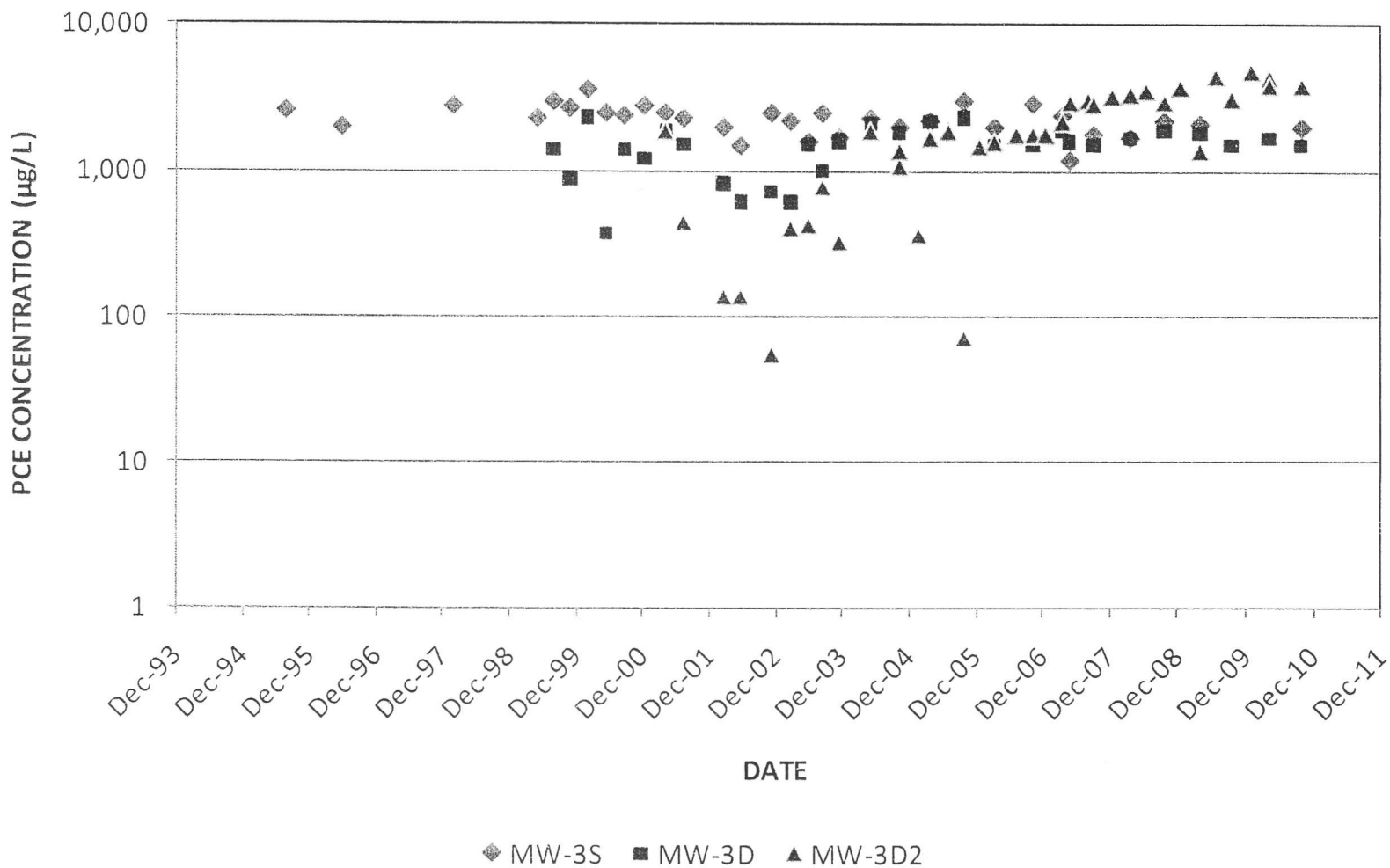

RJN Environmental Services, LLC

Surface Water Studies
Groundwater Studies
Site Investigations

4631 COUNTY ROAD A OREGON, WISCONSIN 53575 (608) 576-3001

MADISON-KIPP CORPORATION
MADISON, WISCONSIN
PCE CONCENTRATIONS - MW-3 NEST

FIGURE

13

DRAWN BY	PROJ. No.	DATE	FILE
RN	09-101	13 JAN 11	MW3 PCE

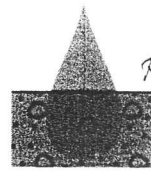
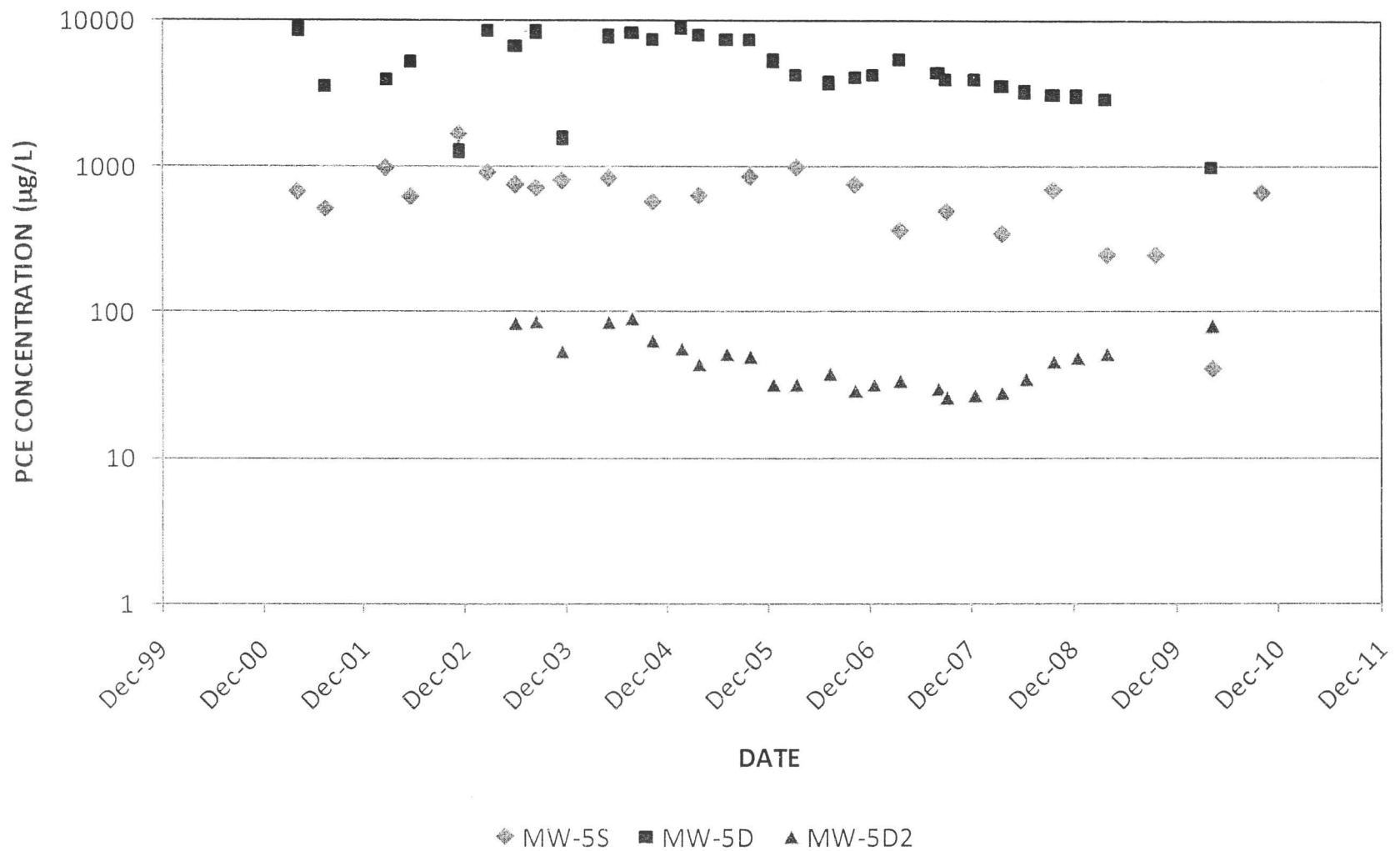

RJN Environmental Services, LLC

Surface Water Studies
Groundwater Studies
Site Investigations

4631 COUNTY ROAD A OREGON, WISCONSIN 53575 (608) 576-3001

MADISON-KIPP CORPORATION
MADISON, WISCONSIN
PCE CONCENTRATIONS - MW-5 NEST

FIGURE
14

DRAWN BY

PROJ. No.

DATE

FILE

RN

09-101

13 JAN 11

MW5 PCE